

NR 1/2" - 3/4" - G1" - M20 - M24 - TMA...

Level - temperature regulator for tank insert
Temperature output 4-20mA

serial No. Date
MA - GB - 300/0 03/23

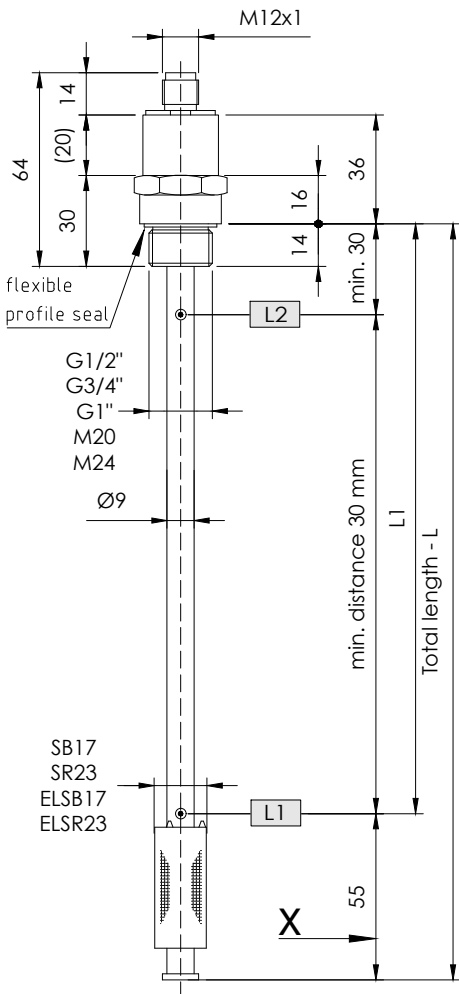

X = L1 - L2 + 1 Thermal kontakt = 70mm

Minimum distance of contacts
see data sheet IN-D-003.

Specimen order

NR1/2"-TMA-SB17-L245-01-L1/190/S-TF70Ö-M12-24V

Tank-connection:

G1/2"
G3/4"
G1"
M20
M24

Float type

SB17
SR23
ELSB17
ELSR23

Total length - L

switching tube (mm)

Level contact type

01 = fixed contact

Switching point L1-L2/
mm from sealing edge

Ö = break

S = make

Function with
increasing level

Thermal contact

TF10Ö

TF40Ö

TF50Ö

TF60Ö (S)

TF70Ö (S)

TF80Ö (S)

TF90Ö

(Ö preferred)

Plug socket-

connector:

M12 - 24V

6+PE-DIN 43651

Operating voltage

VDC 12-30 = 24V

Order code

Plug assignment

Connector variants

Plug assignment

power supply

1 = Temperature

2 = +24VDC

3 - 4 = L1

3 - 5 = L2 (TF)

3 - 6 = TF

Temperature

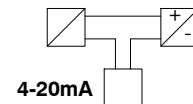

4-20mA

Plug connection

6+PE IP65

EN 175201-804

(DIN 43651)

Plug connection
M12 IP67
5-polig

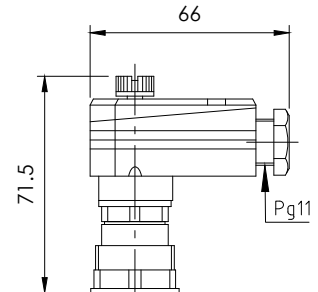
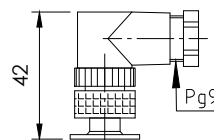

Description

The type NR1/2" - TMA... level controller for installation in tanks is a contactless - operating magnetic switch and is used for monitoring and controlling liquid levels and temperatures.

Bistable protective gas contacts are installed in the switch tube.

For fixed contacts, the contact intervals and their function must be given.

The permanent magnet fitted in the float switches the contacts if the level changes.

The switching difference (hysteresis) is 4 mm. With the TMA version, the temperature-related signal output from a Pt100 mounted in the switch tube is converted to 4-20 mA by the built-in transducer.

The level regulator is maintenance - free when nondeposit media are used. For inductive loads, a protective circuit must be provided (free-wheeling diode/RC element). The device must be installed by specialists only.

The level regulator is maintenance - free when nondeposit media are used.

For inductive loads, a protective circuit must be provided (free-wheeling diode/RC element).

The device must be installed by specialists only.

Max. viscosity 150mm²/S

Technical data

Switch tube

Connecting thread

Brass, max. L = 800mm

Brass: G 1/2", SW27

Brass: G 3/4", SW32

Brass: G 1", SW41

Brass: M20 x 1,5

Brass: M24 x 1,5

1 bar max.

Nominal pressure

Temperature of medium

Float

80°C max.

Hart-PU - SB17, SR23

ELSB17, ELSR23

max. 2, make / break

Datasheet IN-D-003

Datasheet IN-D-003

Level contacts

Switching current

Switching capacity

Operating voltage

Measuring range

Thermal element

Thermal contact

12V ... 30V DC

4-20 mA = 0-100°C

Pt100

Switching point: ±5K

Hysteresis: 20K ±5K

RB = U-12V

20mA

Load

Installed position

Other temperature ranges on request

Vertical ± 30°

Technical data



GOLDAMMER
REGELUNGSTECHNIK GMBH

SCHÖLLERSHEIDER STR. 15

POSTFACH 10 02 17

D-40802 METTMANN

TELEFON 02104/12093

TELEFAX 02104/12028

www.Goldammer-Regelungstechnik.com
info@goldammer-regelungstechnik.com