

NR 1/2" - 3/4" - G1" - M20 - TMA...

Level temperature regulator for tank insert
Temperature output 4-20mA

serial No. Date
MA-GB- 300/0B 03/23

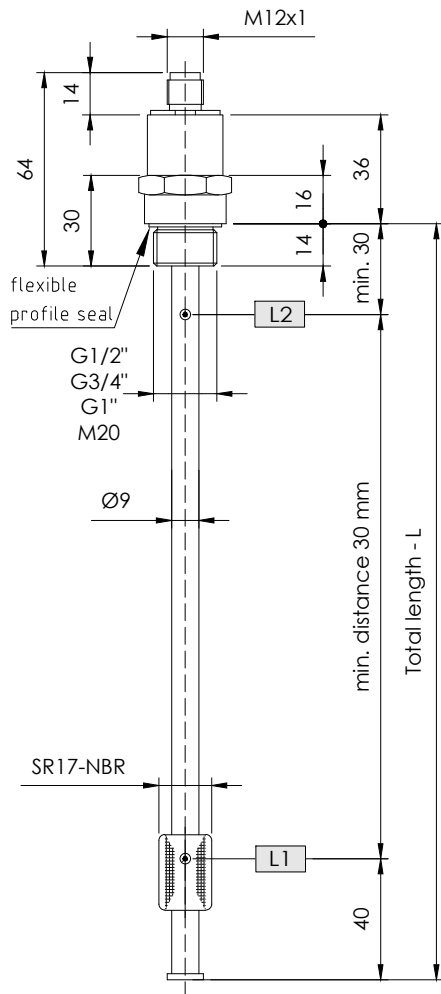

Order code

Specimen order

NR1/2"-TMA-SR17-L245-01M-L1/190/S-M12-24V

Tank-connection:
G1/2"
G3/4"
G1"
M20

Float-Type
SR17

Total Length-L
switching tube (mm)

Level contact-Type
01M = fixed-simple

Plug socket connector:
M12 - 24V
6+PE-DIN 43651

Operating voltage
VDC 12-30 = 24V

Switching point L1-L2/
mm from sealing edge
Ö = break
S = make
Function with
increasing level

Plug assignment

Plug assignment power supply

- 1 = Temperature
- 2 = +24VDC
- 3 - 4 = L1
- 3 - 5 = L2

Temperature

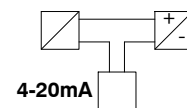

Connector variants

Plug connection
6+PE IP65
EN 175201-804
(DIN 43651)

Plug connection
M12 IP67
5-polig

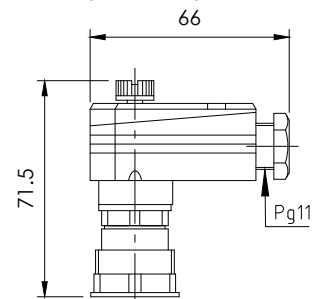
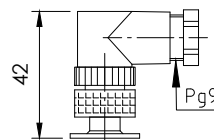

Description

The type NR1/2" - TMA... level controller for installation in tanks is a contactless - operating magnetic switch and is used for monitoring and controlling liquid levels and temperatures.

Bistable protective gas contacts are installed in the switch tube.

For fixed contacts, the contact intervals and their function must be given.

The permanent magnet fitted in the float switches the contacts if the level changes. The switching difference (hysteresis) is 4 mm.

With the TMA version, the temperature-related signal output from a Pt100 mounted in the switch tube is converted to 4-20 mA by the built-in transducer.

The level regulator is maintenance - free when nondeposit media are used. For inductive loads, a protective circuit must be provided (free-wheeling diode/RC element).

The device must be installed by specialists only.

Max. viscosity 150mm²/S

Technical data

Switch tube
Connecting thread

Brass, max. L = 800mm
Brass: G 1/2", SW27
Brass: G 3/4", SW32
Brass: G 1", SW41
Brass: M20 x 1,5

Nominal pressure
Temperature of medium
Float

1 bar max.
80°C max.
SR17 - NBR

Level contacts
Switching current
Switching capacity
Operating voltage
Measuring range
Thermal element
Load

max. 2, make / break
max. 0,7A
max. 10W/VA
12V ... 30V DC
4-20 mA = 0-100°C
Pt100
RB = $\frac{U-12V}{20mA}$

Installed position

Vertical ± 30°

Other temperature ranges on request

Technical data



GOLDAMMER
REGELUNGSTECHNIK GMBH

SCHÖLLERSHEIDER STR. 15 PHONE (49) 2104/12093
P.O.BOX 10 02 17 FAX (49) 2104/12028
D-40802 METTMANN www.Goldammer-Regelungstechnik.com
info@goldammer-regelungstechnik.com