

NR 3/4" - TMA - 150°C

Level - temperature regulator for tank insert
Temperature output 4-20mA

serial No. Date
MA - GB - 302A - 06/24

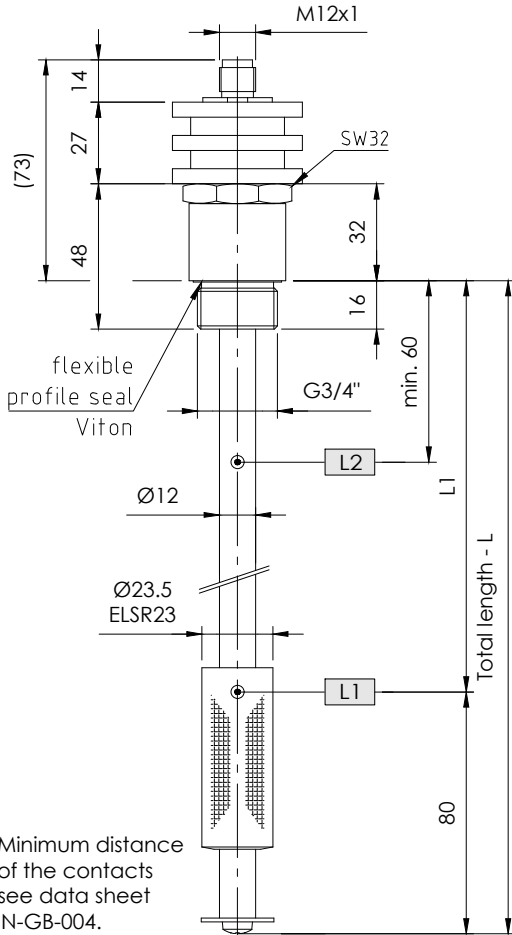

Minimum distance of the contacts see data sheet IN-GB-004.

Plug assignment

- Plug assignment**
power supply
- 1 = Temperature
 - 2 = +24VDC
 - 3 = combined L1-L3
 - 4 = L1
 - 5 = L2
 - 6 = L3

Temperature

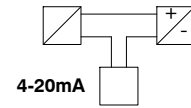

Connector variants

- | | | |
|--|--|--|
| Plug connection
M12 IP67
5-polig | Plug connection
3+PE IP65
EN 175301-803
(DIN 43650) | Plug connection
6+PE IP65
EN 175201-804
(DIN 43651) |
|--|--|--|

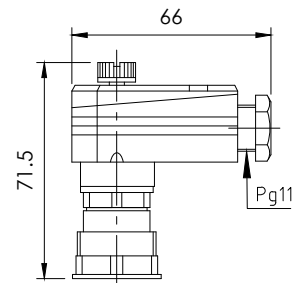
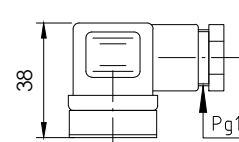
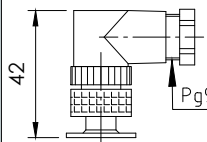

Specimen order

NR3/4" - TMA - 150°C - EL SR23 - L370 - 02 - L1/300/S - L2/80/S - M12 - 24V

Order code	Tank connection: G 3/4"	Float - type EL SR23	Total length-L of switching tube(mm)	Switching point L1-L3/ mm from sealing edge W= changeover Function with increasing level	Plug socket connector: M12 - 24V 3+PE-DIN 43650 6+PE-DIN 43651
			Level contact type 02 = fixed, changeover		

Description

The level regulator type NR 3/4" - TMA - 150°C for tank insert is a solenoid switch operating without contact with the function of monitoring and regulating liquid levels and temperatures. Bistable protective gas contacts are permanently arranged in the switching tube. The contacts can be connected as changeover contact, break contact and make contact. The permanent magnet built into the float switches the contacts when the level changes. The switching difference (hysteresis) is 4 mm. For temperature monitoring, the temperature-dependent signal emitted by a Pt100 resistor mounted in the switching tube is converted into a temperature-linear current change of 4-20mA using the built-in transmitter. The level controller is maintenance - free when nondeposit media are used. In the case of remote installation, care must be taken to ensure a low-loss connection between the display unit and the sensor tube. For inductive loads, a protective circuit must be provided (free-wheeling diode/RC element).

The device must only be installed by specialists.

Max. viscosity 150mm²/S

Technical data

Switch tube	Stainless steel (VA) max. L = 1000mm
Connecting flange	G3/4", SW32 (VA) Stainless steel with flat seal Viton
Nominal pressure	10 bar max. - Float EL SR23
Temperature of medium	150°C max.
Float	Type: EL SR23, Ceramic bistabil, changeover
Level contacts	Datasheet IN-GB-004
Switching current	Datasheet IN-GB-004
Switching capacity	Datasheet IN-GB-004
Operating voltage	12V ... 30V DC
Measuring range	4-20 mA = 0-160°C
Thermal element	Pt100 Datasheet IN-GB-005
Load	RB = U-12V 20mA
Number of functions	max. 3 adjustable
Installed position	vertical ± 30°

Other temperature ranges on request.



GOLDAMMER
REGELUNGSTECHNIK GMBH

SCHÖLLERSHEIDER STR. 15
POSTFACH 10 02 17
D-40802 METTMANN

TELEFON 02104/12093
TELEFAX 02104/12028

www.Goldammer-Regelungstechnik.com
info@goldammer-regelungstechnik.com