

NR 3/4" - MA

Level - temperature regulator with resistance measuring chain and resistance thermometer, output 4-20 mA

serial No. Date
MA - GB - 305/A2 04/24

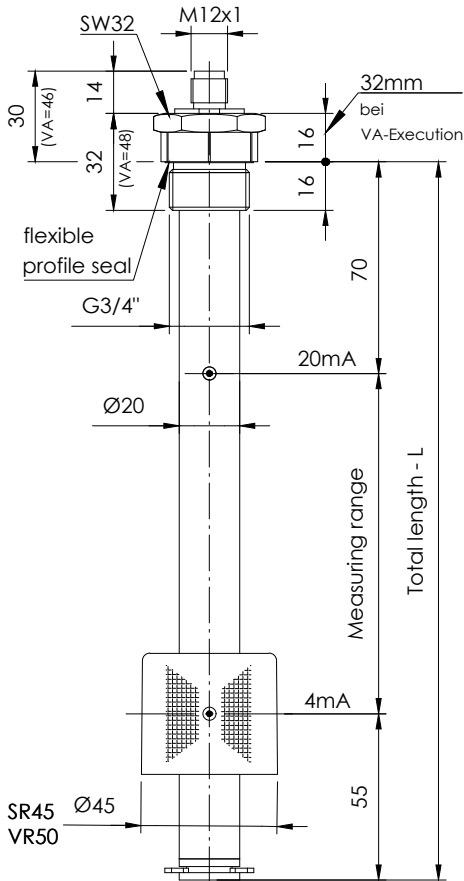

Float mounting via manhole.
Pay attention to the installation marking.

Order code

Specimen order

NR3/4"-MA-SR45-L300-T-0-MS-M12

Tank-connection:
G3/4"

Float-Type
SR45
VR50

Total length-L (special length)
switching tube (mm)

Standard length

L=250 L=900 L=1500
L=370 L=1000 L=1600
L=500 L=1100 L=1700
L=600 L=1200 L=1800
L=700 L=1300 L=1900
L=800 L=1400 L=2000

Execution:
MS - Brass
VA - Stainless steel
Tank connection,
Switching tube

0 = together
1 = separately

T = Temperature
O = without Temperature

Plug socket connector:
M12
6+PE-DIN 43651
3+PE-DIN 43650
3 pol. + PE

Plug assignment

Plug assignment power supply

3-polig + PE
EN 175301-803 (DIN 43650)

Level 1 = +12-30V DC
2 = Level

M12 - 5 polig

Level 1 = +12-30V DC
4 = Level

3-polig + PE
EN 175301-803 (DIN 43650)

Level 1 = +12-30V DC
2 = Level
3 = Temperature

M12 - 5-polig

and

6+PE - EN 175201-804 (DIN 43651)

Level 1 = +12-30V DC
+ Temperature 4 = Level
2 = Temperature

getrennt

Level 1 = +12-30V DC
4 = Level
+ Temperature 2 = +12-30V DC
3 = Temperature

Plug connection
6+PE IP65
EN 175201-804
(DIN 43651)

Plug connection
3+PE IP65
EN 175301-803
(DIN 43650)

Plug connection
3 pol.+PE
IP67

Connector variants

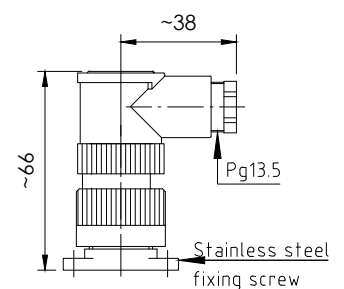
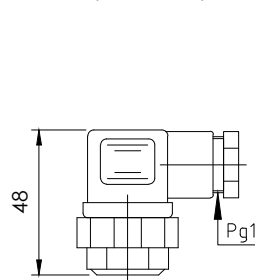
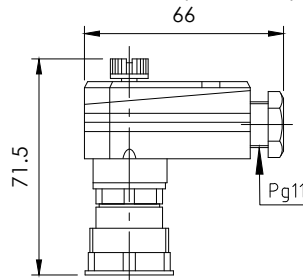
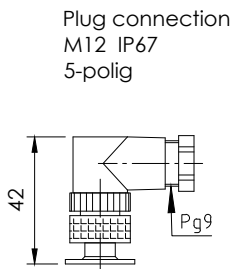

Technical data

Description

The level temperature regulator type NR 3/4"-MA for installation in tanks is a non-contact electromagnetic switch and is used for continuous remote transmission of liquid levels and temperatures. Level and temperature can be continuously evaluated via arbitrarily long cables for automatic control and display. The level regulator contains a resistance measurement chain and a Pt100 resistor. The level- and temperature-dependent signal is converted into a linear current change of 4-20mA in the built-in transmitter. The level regulator is maintenance-free for non-built-up media. As an option, permanently arranged bistable level contacts can also be installed. The float is mounted via a manhole.

The device may only be installed by qualified personnel.

Max. Viskosität 320mm²/S

Technical data

| | |
|--------------------------|--|
| Switch tube | Brass (MS), Stainless steel (VA) |
| | max. L = 2000mm |
| Tank connection | MS / G 3/4", SW32 VA / G 3/4", SW32 |
| Nominal pressure / Float | 1 bar max. - Float SR45, Hart PU 10 bar max. - Float VR50, VA |
| Temperature of medium | 100°C max. |
| Operating voltage | 12V...30V DC |
| Measuring range | 4-20mA=0-100°C |
| Thermal element | Pt100 |
| Contact grid | 7,5mm |
| Load | RB = U-12V 20mA |
| Installed position | vertical ± 30° |

Other temperature ranges on request.



GOLDAMMER
REGELUNGSTECHNIK GMBH

SCHÖLLERSHEIDER STR. 15
POSTFACH 10 02 17
D-40802 METTMANN

TELEFON 02104/12093
TELEFAX 02104/12028

www.Goldammer-Regelungstechnik.com
info@goldammer-regelungstechnik.com